

**HP58 DIMENSIONS & GENERAL PIN OUTS**

**MAGNET NOTE:**

STANDARD MAGNET INCLUDED AS ACCESSORY WITH PURCHASE OF NON-CONTACT SENSOR

**STANDARD MAGNET**

MAG-H-RING-ASSM.  
1/4-20 X .47

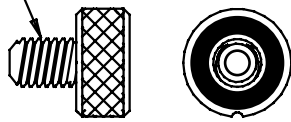

**HOUSING/INSTALL NOTES:**

MAGNET MOUNT MATERIALS MUST HAVE Ø1.0 [25.4] HOLE CENTERED ON SENSOR CENTERLINE

NON-MAGNETIC MOUNT MATERIAL, MAY BE SOLID

MOUNT WITH 316 STAINLESS STEEL 4-40 SCREWS

OPTIONAL CABLE SIDE OUTLET  
CABLE WITH FLYING LEADS  
OR CABLE WITH M12-5

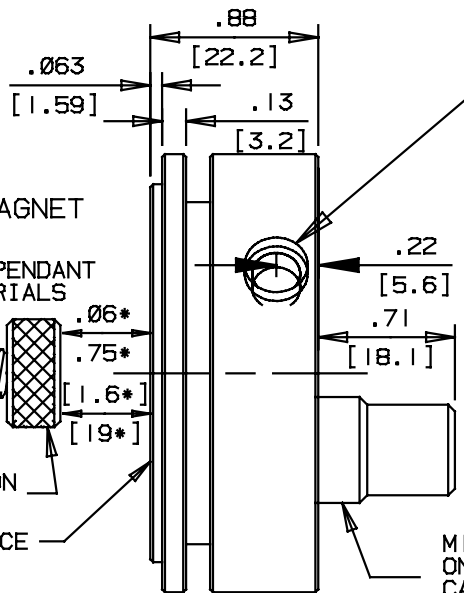

ALLOWED MAGNET DISTANCE

\* DISTANCE DEPENDANT ON MOUNT MATERIALS

APPLICATION MAGNET

SENSOR FACE

M12-5P OMITTED ON SIDE OUTLET, CABLE & FLYING LEAD VERSIONS.

**SENSOR FACE**

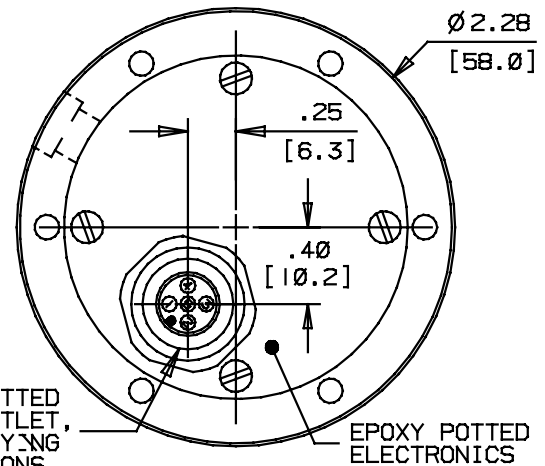
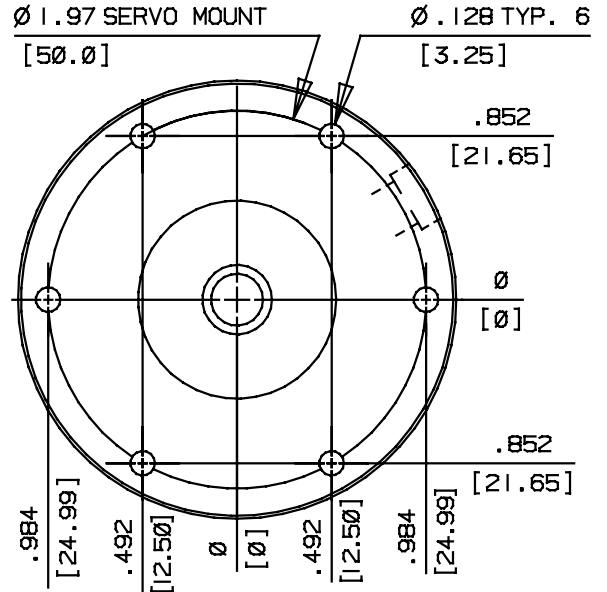

**DT04-4P MALE FACE VIEW**



**DT04-4P J1939 OUTPUT**

- 1 = YEL = CAN HIGH
- 2 = GRN = CAN LOW
- 3 = RED = +VDC (VIN)
- 4 = BLK = COMMON/GROUND

**M12-5P MALE FACE VIEW**

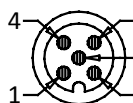

**M12-5P/CABLE/FLYING LEAD QUADRATURE OUTPUT**

- 1 = BRN = +VDC (VIN)
- 2 = WHT = CHANNEL B
- 3 = BLUE = COMMON/GROUND
- 4 = BLK = CHANNEL A
- 5 = GRY = CHANNEL Z

**M12-5P/CABLE/FLYING LEAD PROPORTIONAL (ANALOG) OUTPUT**

- 1 = BRN = +VDC (VIN)
- 2 = WHT = DIG. LIMIT OUT\*
- 3 = BLUE = COMMON/GROUND
- 4 = BLK = PROP. VDC OUTPUT
- 5 = GRY = NOT USED

\*OPTION CONSULT FACTORY

**DT04-6P MALE FACE VIEW**

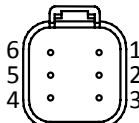

**DT04-6P J1939 OUTPUT**

- 1 = YEL = CAN HIGH
- 2 = GRN = CAN LOW
- 3 = RED = +VDC (VIN)
- 4 = BLK = ADDRESS GROUND
- 5 = WHT = ADDRESS PROG. RESISTOR
- 6 = BLK = COMMON/GROUND

**M12-5P AND 5 CONDUCTOR CABLE J1939 OUTPUT**

- 1 = BRN = +VDC (VIN)
- 2 = WHT = CAN HIGH
- 3 = BLUE = COMMON/GROUND
- 4 = BLK = CAN LOW
- 5 = GRY = OPTIONAL ADDRESS PROGRAMMING RESISTOR

Dimensions informative only  
For most recent dimensions please consult factory

